

RIDGE



Picture a seamless illuminated band stretching across the span of a bridge; its even, powerful, punchy white glow is a sign of unwavering reliability. Rain lashes down, and winds howl, yet its luminosity remains steadfast for this architectural marvel.

It's the way we design lighting that embodies our values. Highly engineered, high-performance LEDs tailored for linear lighting applications and a dedicated mounting system, Ridge gives lighting designers a wide range of application options. With an innovative and easy connectivity system that fits today's lighting needs, Ridge strikes a balance of practicality, flexibility, and performance.

RIDGE

Iconic to the Core



IT'S IN THE DETAILS

Tower: SAF28, SAF14, SAF7, SAF1 SW 4000K
Main Girder: Ridge U4 90CRI 40K 40x60DEG

THAT BUILDS LANDMARKS

Tower: SAF28, SAF14, SAF7, SAF1 RGBW4
Main Girder: Ridge U4 90CRI RGBW4 40x60DEG

ICONIC TO THE CORE

Ridge is conceived as a design-forward solution for today's environment. Its low-profile linear form integrates seamlessly into façades and architecture, delivering precise illumination without visual clutter. By harmonizing advanced optics with human-centric lighting principles, Ridge elevates spaces with light that is both functional and expressive.



GREAT DESIGN IS TRANSPARENT

MORE POWER: 2100 lm/ft and up to 24 W/ft

HIGHER SATURATON: RGBW Quad Tech, tailored high-clarity acrylic optics, and more LED clusters

WATERPROOF: Features a robust die-cast aluminum construction with a permanently bonded silicone seal creating an impermeable barrier against water.

ROBUST: 3G, 5G, IK10, IP67, BAA, BABA

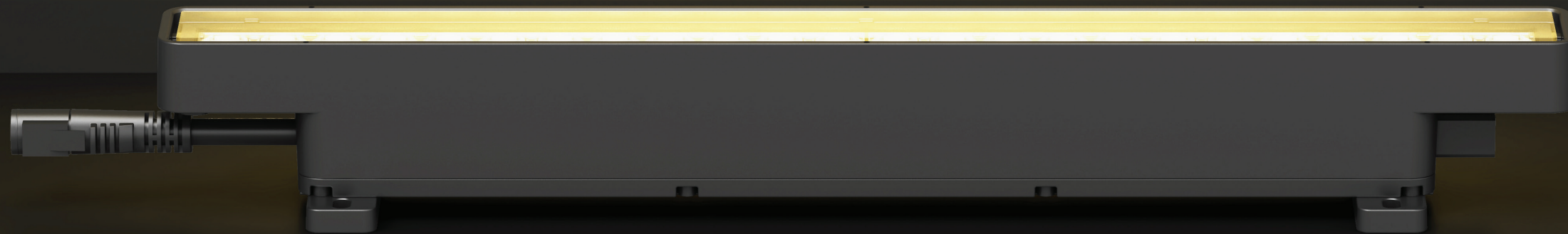

WINDING CURVES

- 1-foot nominal length
- Tight or constrained spaces
- Complex and non-linear layouts

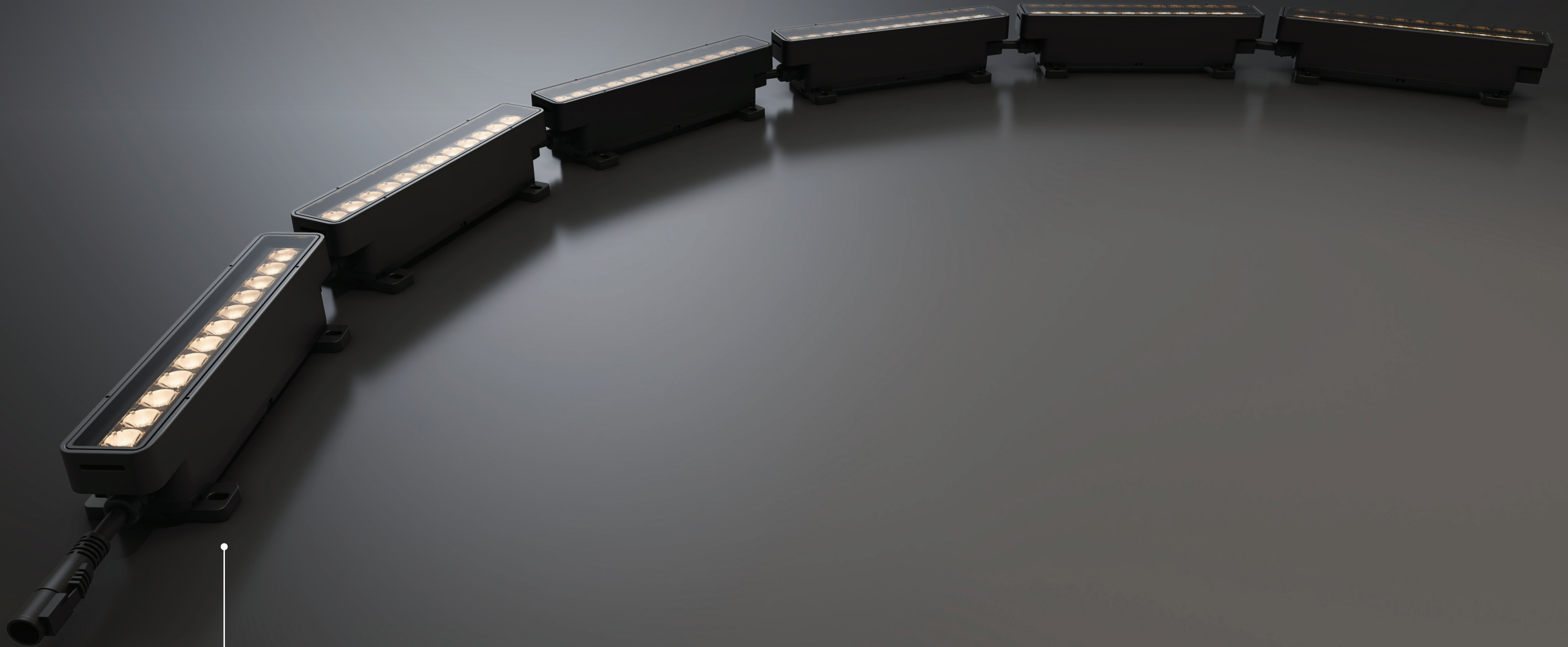

UNIVERSAL NON-ADJUSTABLE
SLIM MOUNT

PERFECTED ILLUMINATION

Façade: Ridge U4 90 CRI 30K 9x9DEG
Tunnel: Ridge U4 90CRI RGBW 40x60DEG with louver option
Pathway: Wander1 PM1 SW H38 35000K



FOR CLOSE SETBACKS

Façade: Ridge U4 90 CRI 30K 9x9DEG
Tunnel: Ridge U4 90CRI RGBW 40x60DEG with louver option
Pathway: Wander1 PM1 SW H38 35000K



SERENE SETTINGS

Façade: Ridge U4 90 CRI 30K 9x9DEG
Tunnel: Ridge U4 90CRI RGBW 40x60DEG with louver option
Pathway: Wander1 PM1 SW H38 35000K

AND DYNAMIC SPACES

Façade: Ridge U4 90 CRI 30K 9x9DEG
Tunnel: Ridge U4 90CRI RGBW 40x60DEG with louver option
Pathway: Wander1 PM1 SW H38 35000K

NO COMPROMISES

Ridge empowers designers with flexibility and control. RGBW Quad Tech unlocks a full spectrum of color, while the Power Scaling driver maintains saturation without sacrificing lumen output. Proprietary linear LEDs deliver crisp whites and uniform distribution, enabling precise light modeling across architectural surfaces. Ridge is more than a luminaire—it's a tool for shaping visual identity through light.

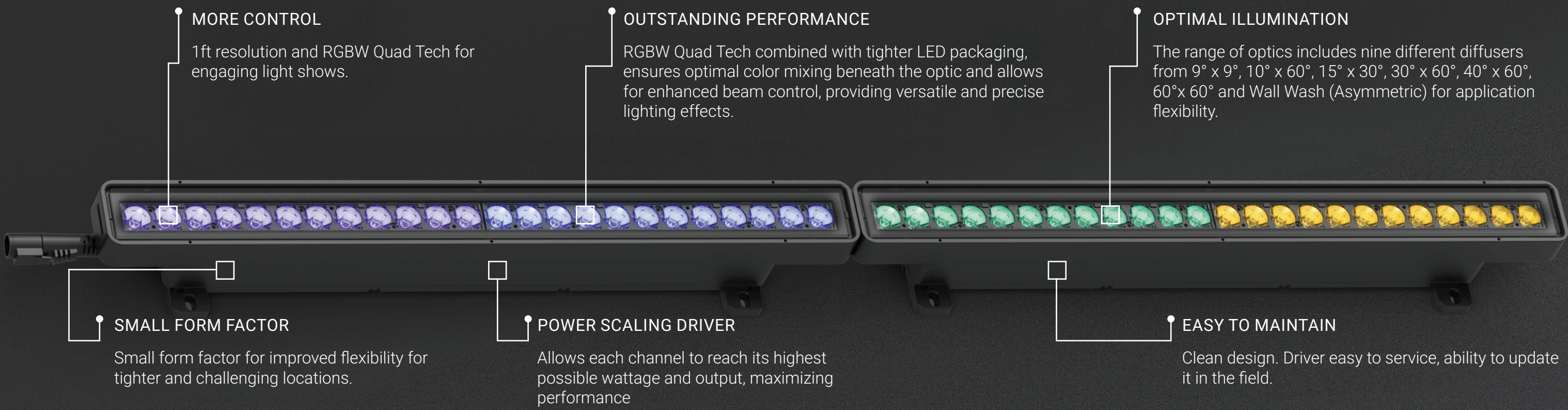

NUMEROUS OPTIONS

1ft, 2ft, 3ft and 4ft nominal lengths available. 18 mounts, glare control, 3 linear plans, color and 9 color temperatures.

EASY UPDATES

- Update driver by removing base plate
- Mount stays in place
- No need to pull out the gasket
- Easier replacement of the driver without disturbing other components or compromising the fixture's integrity

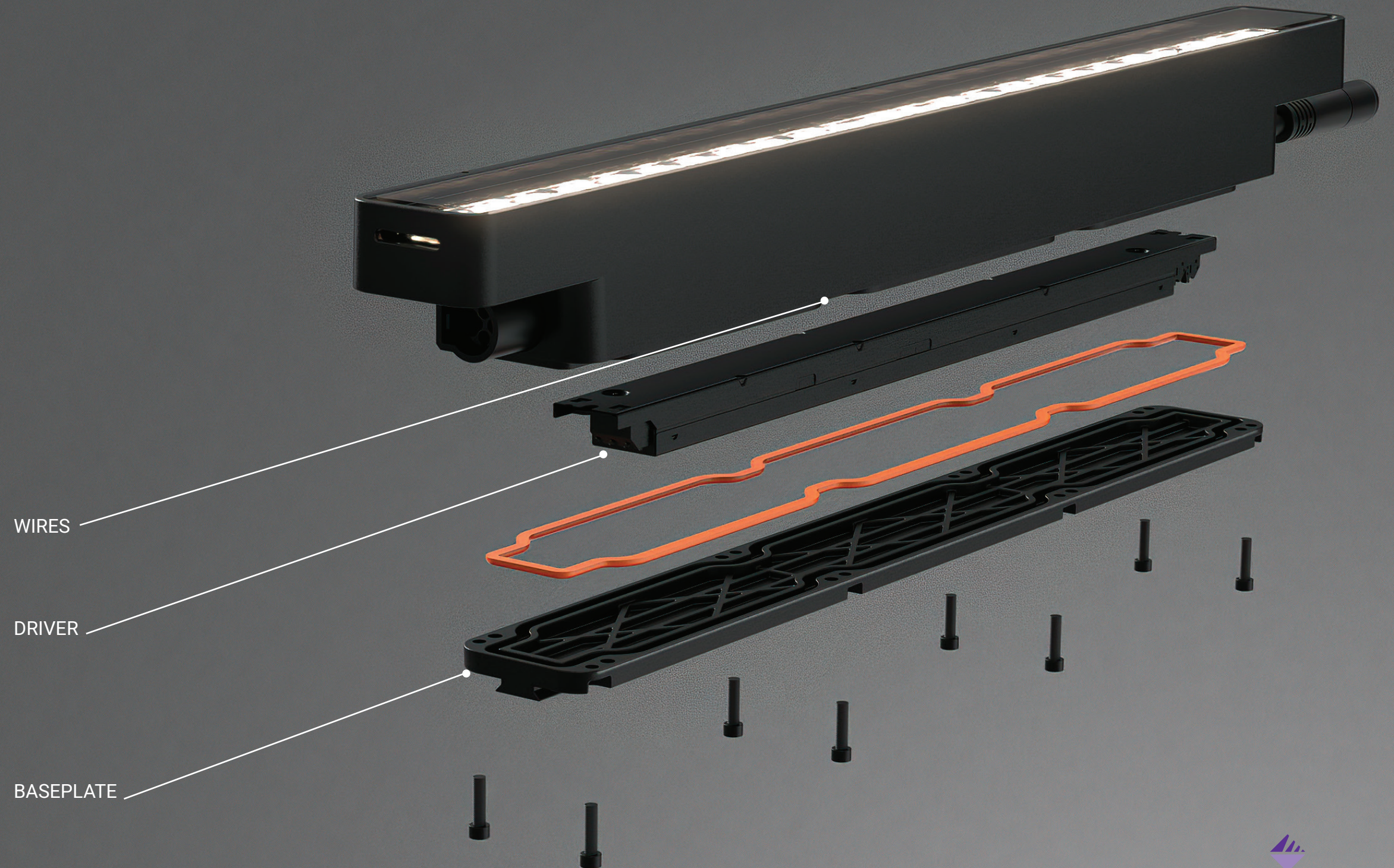

TOP-DOWN DESIGN

Every detail of Ridge speaks to architectural integrity. The housing eliminates conventional screw-based assemblies, resulting in a clean, uninterrupted geometry that resists water ingress at critical junctions. A die-cast aluminum structure, minimal fasteners, and a permanently bonded seal combine to create an impermeable barrier—ensuring longevity and performance in demanding exterior applications.

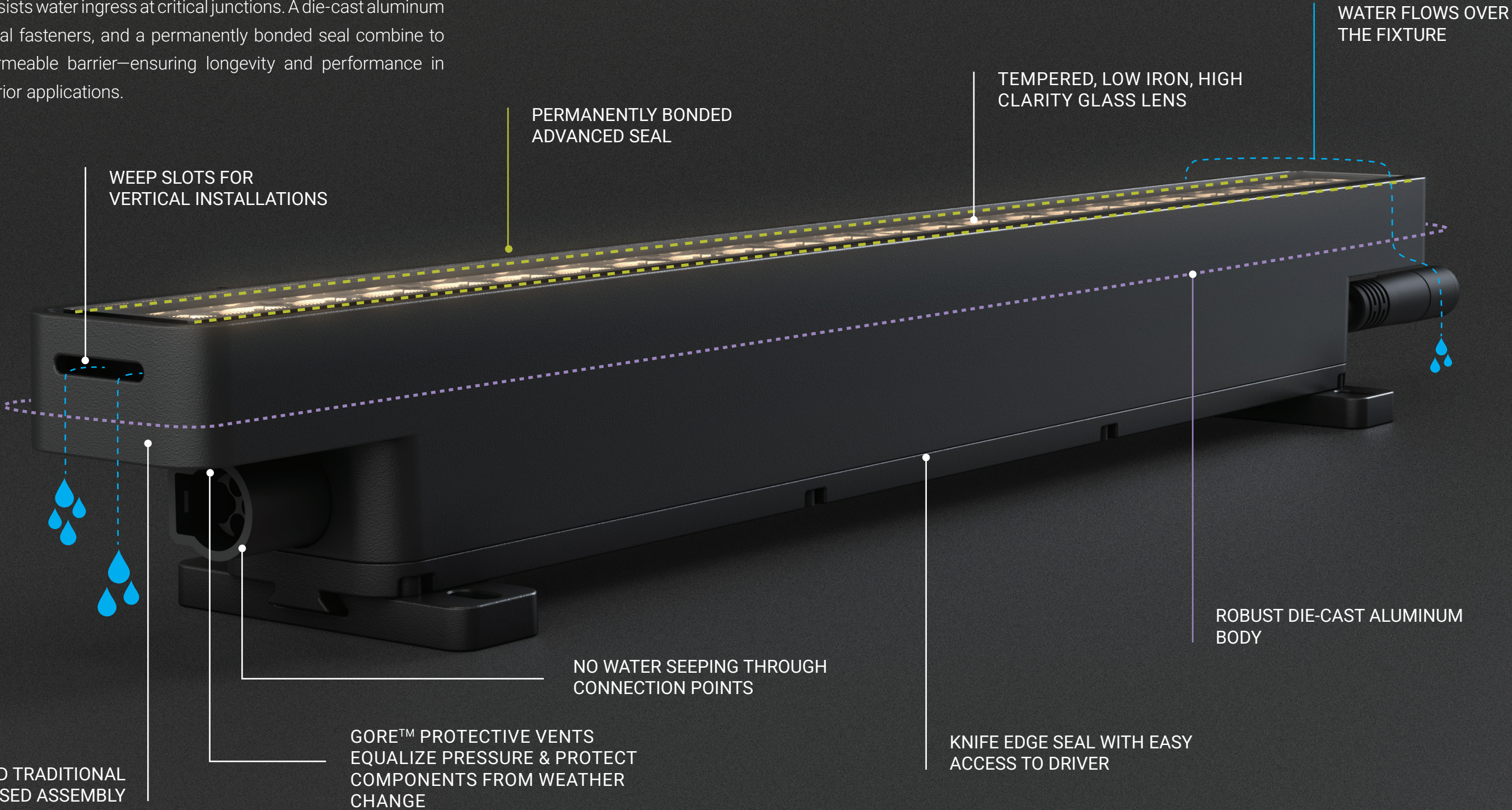

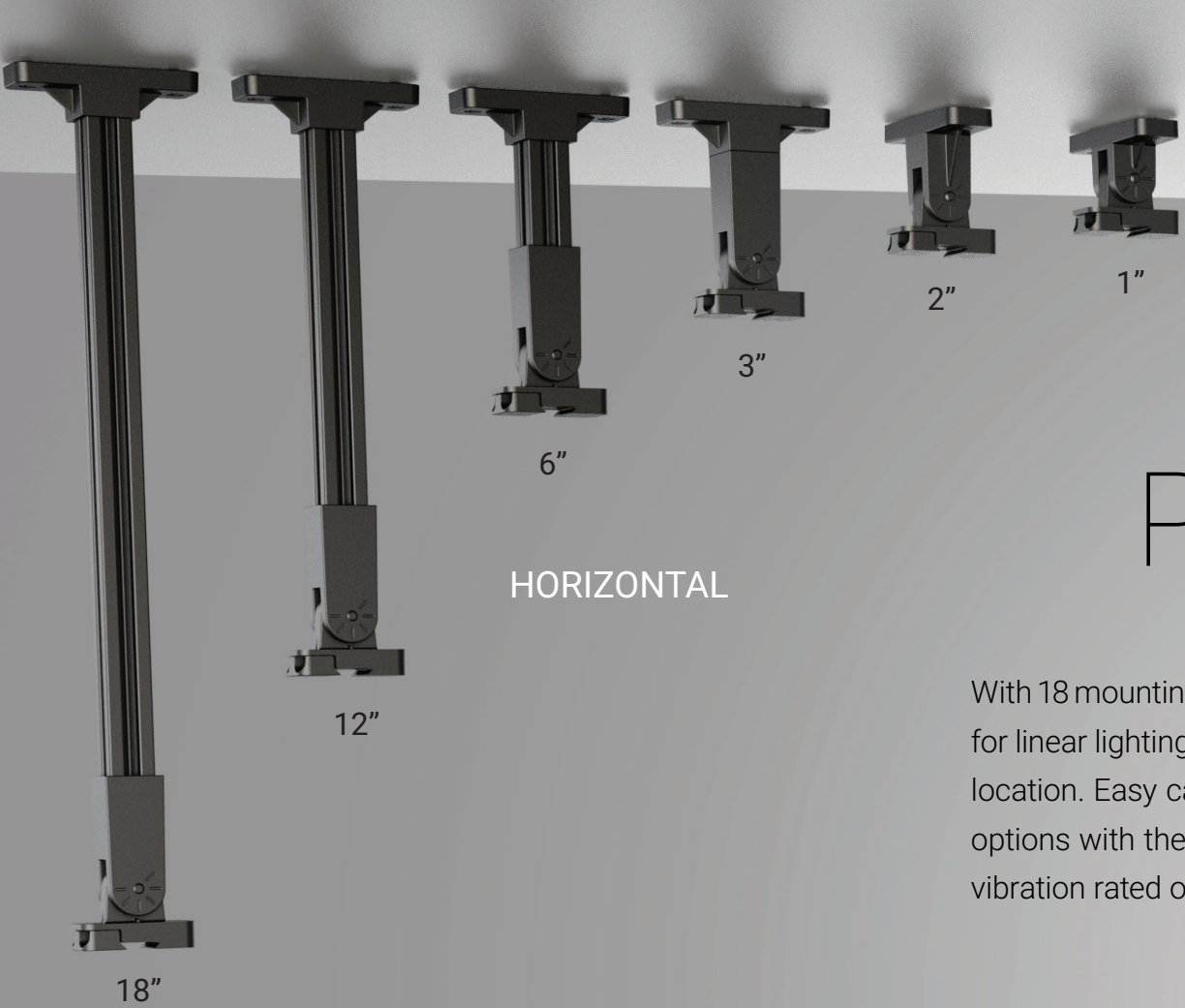

HORIZONTAL

MOUNTING POSSIBILITIES

With 18 mounting options that are exclusive to Ridge, the linear family fulfils the many demands for linear lighting applications. A unique pivot and slide feature ensures a near-perfect lighting location. Easy cabling system, improved installation flexibility, and field-adjustable mounting options with the Taper-Lock mechanism significantly enhance Ridge's versatility. 3G and 5G vibration rated option also included!



HORIZONTAL

UNIVERSAL

ADJUSTABLE
INSIDE

FIXED,
FLEX

FIXED,
SLIM

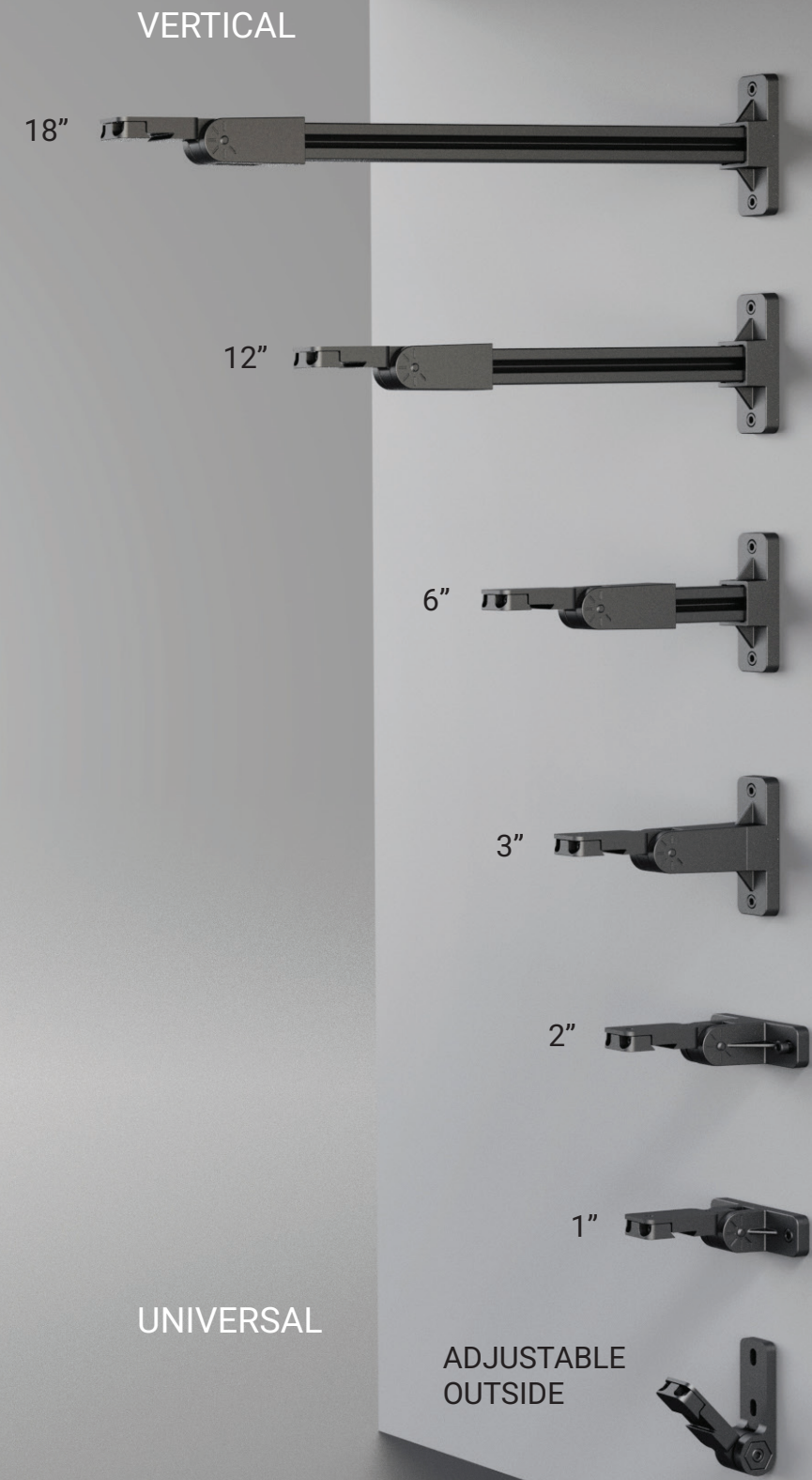

VERTICAL

UNIVERSAL

ADJUSTABLE
OUTSIDE

HORIZONTAL

FREEDOM OF CHOICE

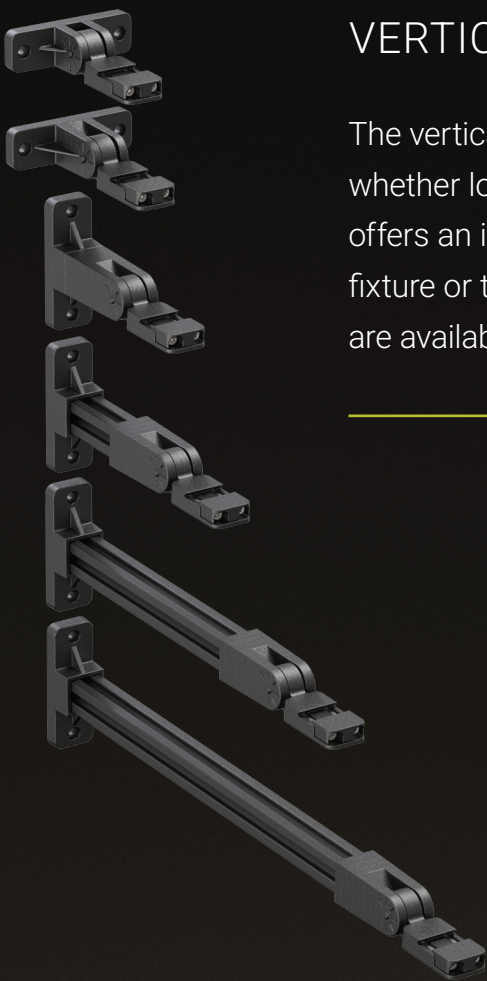

VERTICAL ADJUSTABLE

The vertical mount minimizes its visual impact whether looking above or below the fixture. It offers an impressive tilt range, only limited by the fixture or the surface. 5G vibration-rated options are available with the 1" and 2" mounts.



STAKE | GROUND

Maintains balance throughout the 180-degree tilt range with a slide and pivot mechanism that keeps the luminaire's weight centered. Applicable for ground applications.

HORIZONTAL ADJUSTABLE

Maintains balance throughout the 180-degree tilt range involves a unique slide and pivot mechanism that keeps the luminaire's weight centered over the Horizontal mount. Applicable with upward or downward facing applications. 5G vibration-rated options are available with the 1" and 2" mounts.



UNIVERSAL

A form-fitting mount with a fixed or adjustable arm and compatible with horizontal and vertical surfaces. Versatile, ease of installation and a 3G or 5G vibration-rated options are available.

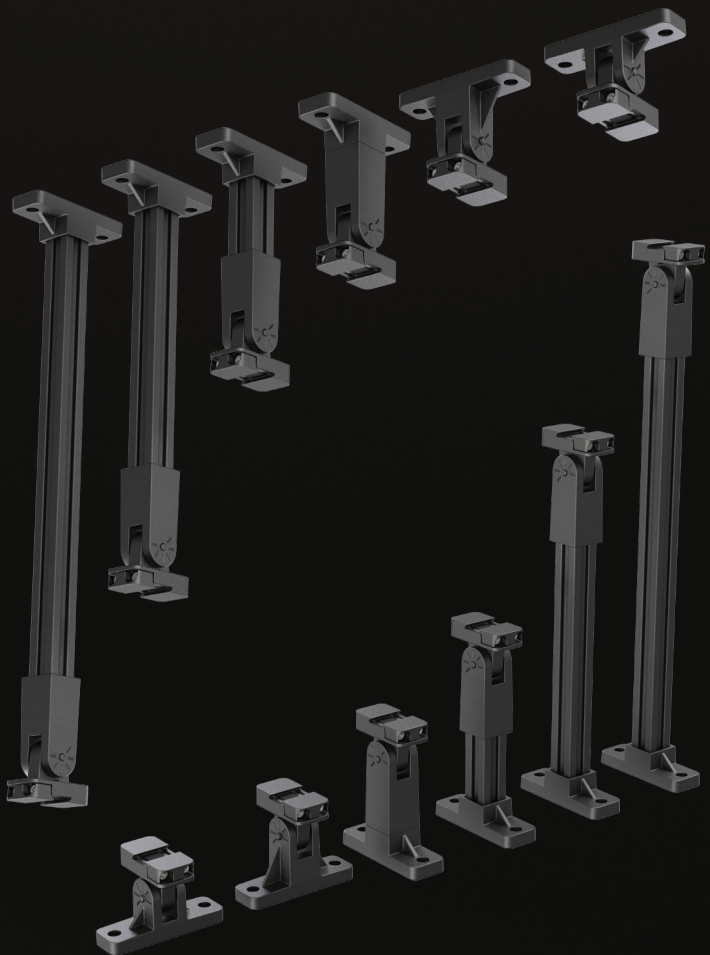

A CLOSER LOOK



Vertical 3"



Universal Adjustable Outside



Horizontal 12"



Stake 12"



Universal Adjustable Inside

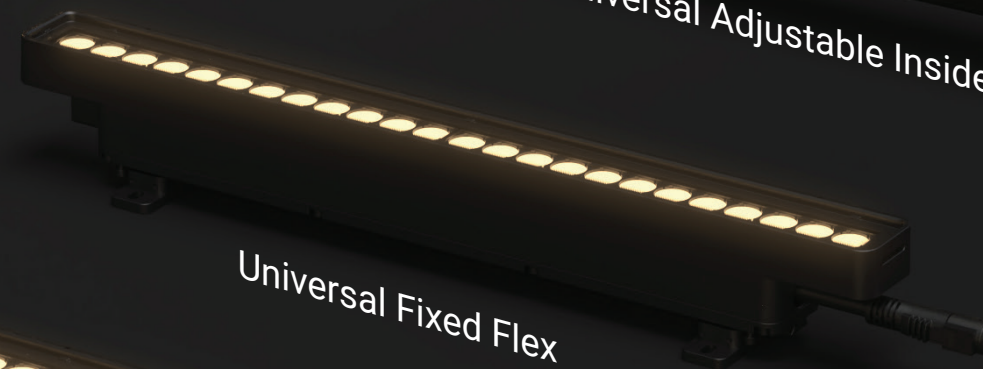

Universal Fixed Flex



Universal Fixed Slim

PIVOT AND SLIDE

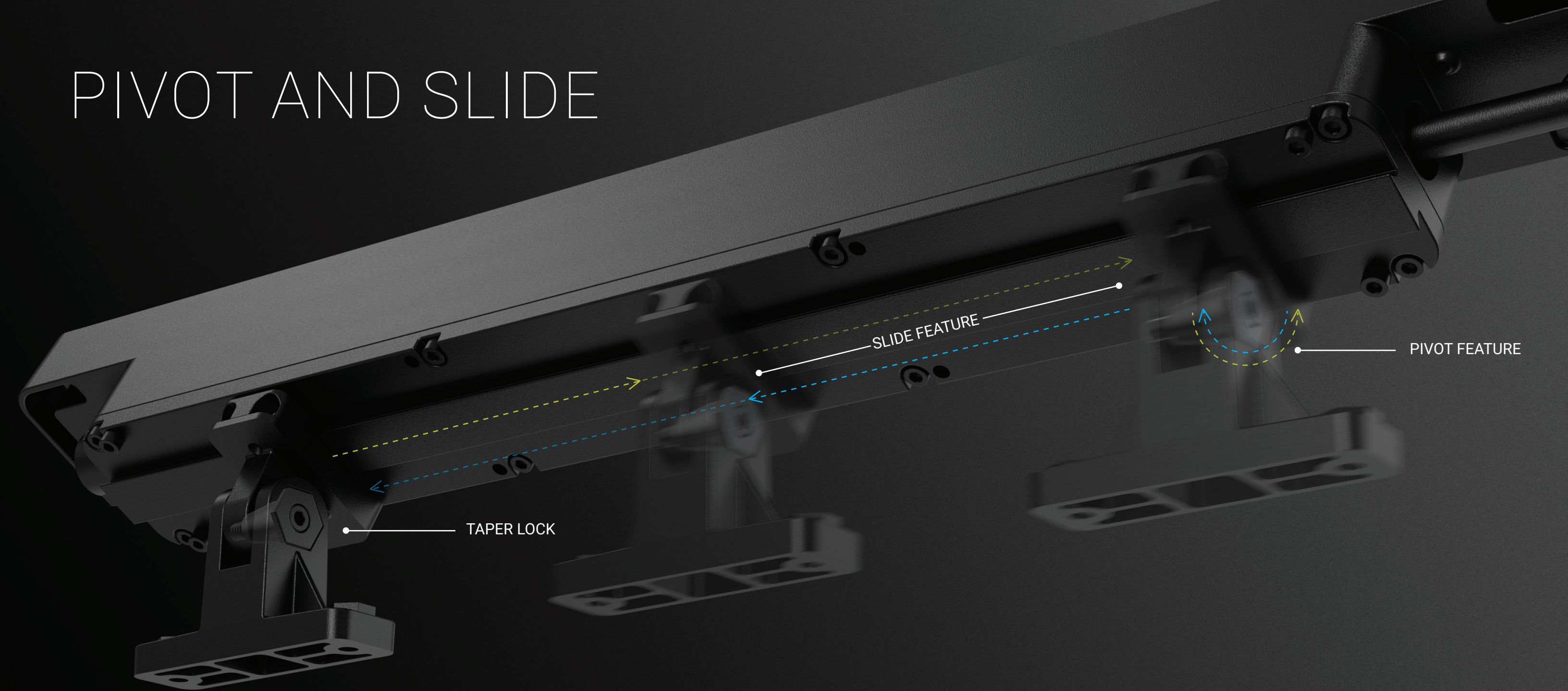

INFINITE COLOR SELECTION

RGBW Quad Tech utilizes advanced optical color mixing to eliminate striations and color separation, ensuring seamless, vibrant illumination. Designed with the Power Scaling driver to ensure each channel achieves maximum wattage and output, resulting in a highly efficient luminaire that offers maximum performance and brightness.

- 1ft, 2ft, 3ft, 4ft nominal lengths
- Optional 1FT resolution control
- No color separation or loss of lumen output
- No overheating of fixture
- Precise color matching
- Prevents striations and color separation in wall grazing or wall-washing applications
- Up to 6,400 delivered lumens, 1,700 lm/ft & 110,600 CBCP

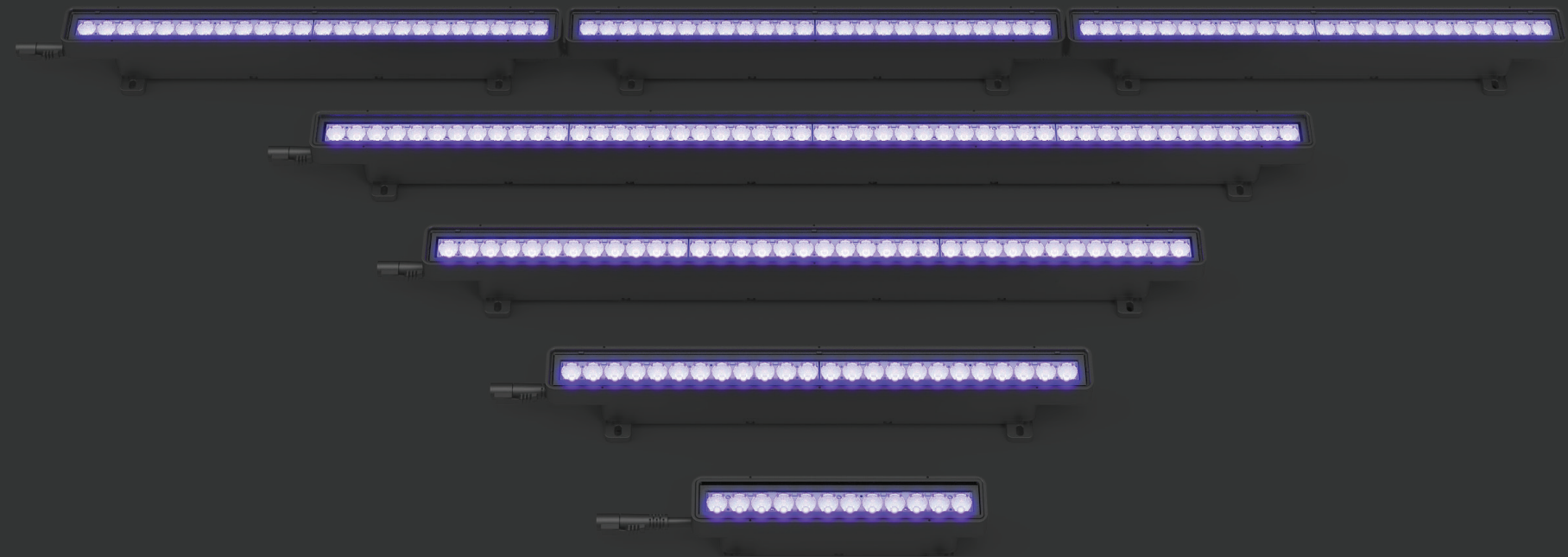

RGBW Quad Tech

GET READY



Stadium: Ridge U4 RGBW5 9x9
Pathway and step lighting: SAF1 SW 4000K 100Deg (Poles available at [Acuitybrands.com](https://www.acuitybrands.com))

ITS SHOW TIME!



PEAK PERFECTION

Hotel Entrance Ceiling: RIDGE U4 P4 90CRI 40K VWD
Hotel Entrance Front Façade: RIDGE U4 P4 90CRI 40K 40X60DEG LVR
Hotel Extended Frame: RIDGE U4 P4 90CRI 40K 9X9DEG

DETAILED APPLICATIONS

The Ridge linear floodlight family provides precise resolution control down to just 1 foot, enabling highly detailed and accurate lighting design for outdoor applications. Its advanced optics and control technology allow users to customize light distribution and focus with exceptional precision when details matter. The Ridge family's versatile features ensure that every project achieves optimal visual impact with unmatched control and flexibility.

- Intricate lighting effects
- Dynamic color changes
- Precise spatial lighting design

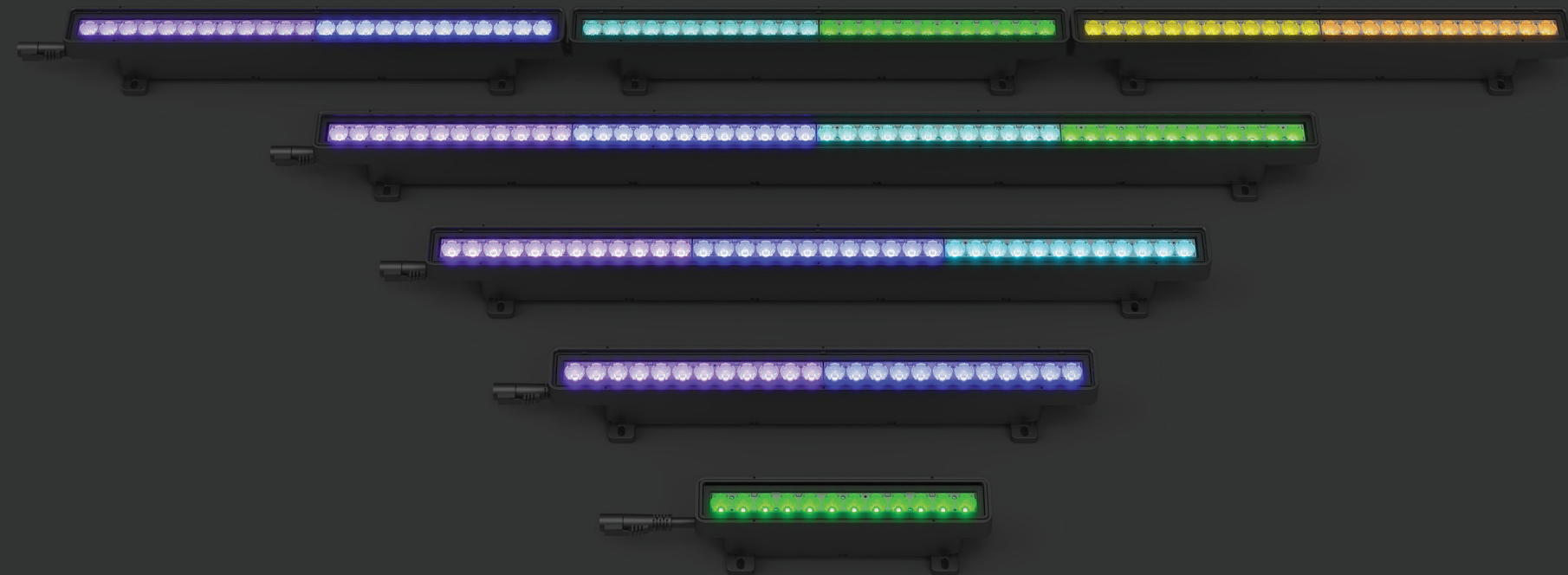

1 ft Resolution

DRAMA UNFOLDS



Windowsill: (2) 3ft linear RGBW3

ART COLLECTIVE



Windowsill: (2) 3ft linear RGBW3

TAKE FLIGHT

Terminal Cantilevered Roof: Ridge 90CRI RGBW 10x60DEG UFXS HVSR
Departure Curbside: SAF1 35K 100DEG C3

STATIC WHITE, ELEVATED

Offering high color rendering, Ridge delivers vibrant, natural illumination for outdoor spaces with up to 9,000 delivered lumens—2,100 lumens per foot and a powerful 150,000 candela beam candlepower. Its custom optical system ensures excellent uniformity, while precision acrylic optics provide superior beam quality and control.

- 1ft, 2ft, 3ft, 4ft nominal length
- 9 color temperatures including AMBLW
- 7 distributions including wall wash
- DALI, DMX/RDM, 0-10V, ELV
- 80 CRI, 90 CRI
- Precision acrylic optical system for excellent uniformity
- Up to 9000 delivered lumens, 2100 lm/ft & 150,000 CBCP

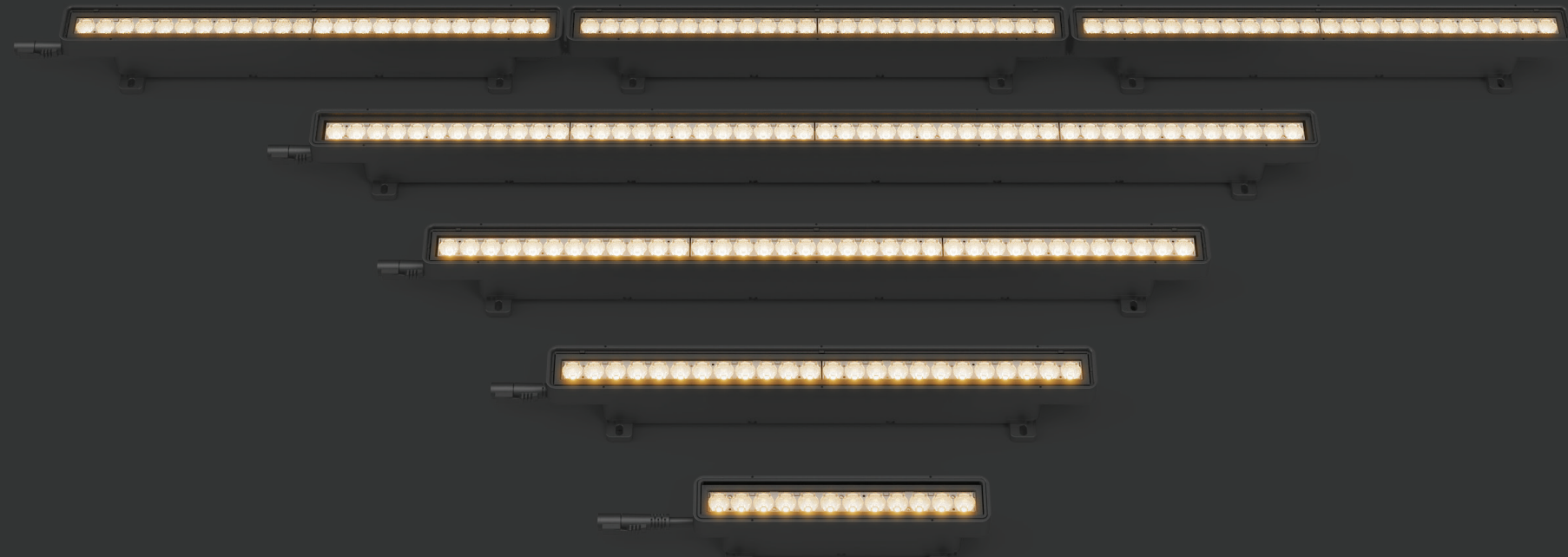

Static White

DESIGN FLEXIBILITY



Front façade: RIDGE U1 P1 80CRI 40K 9X9DEG
Side façade: SAF1 SW and RGBW

FLYING HIGH

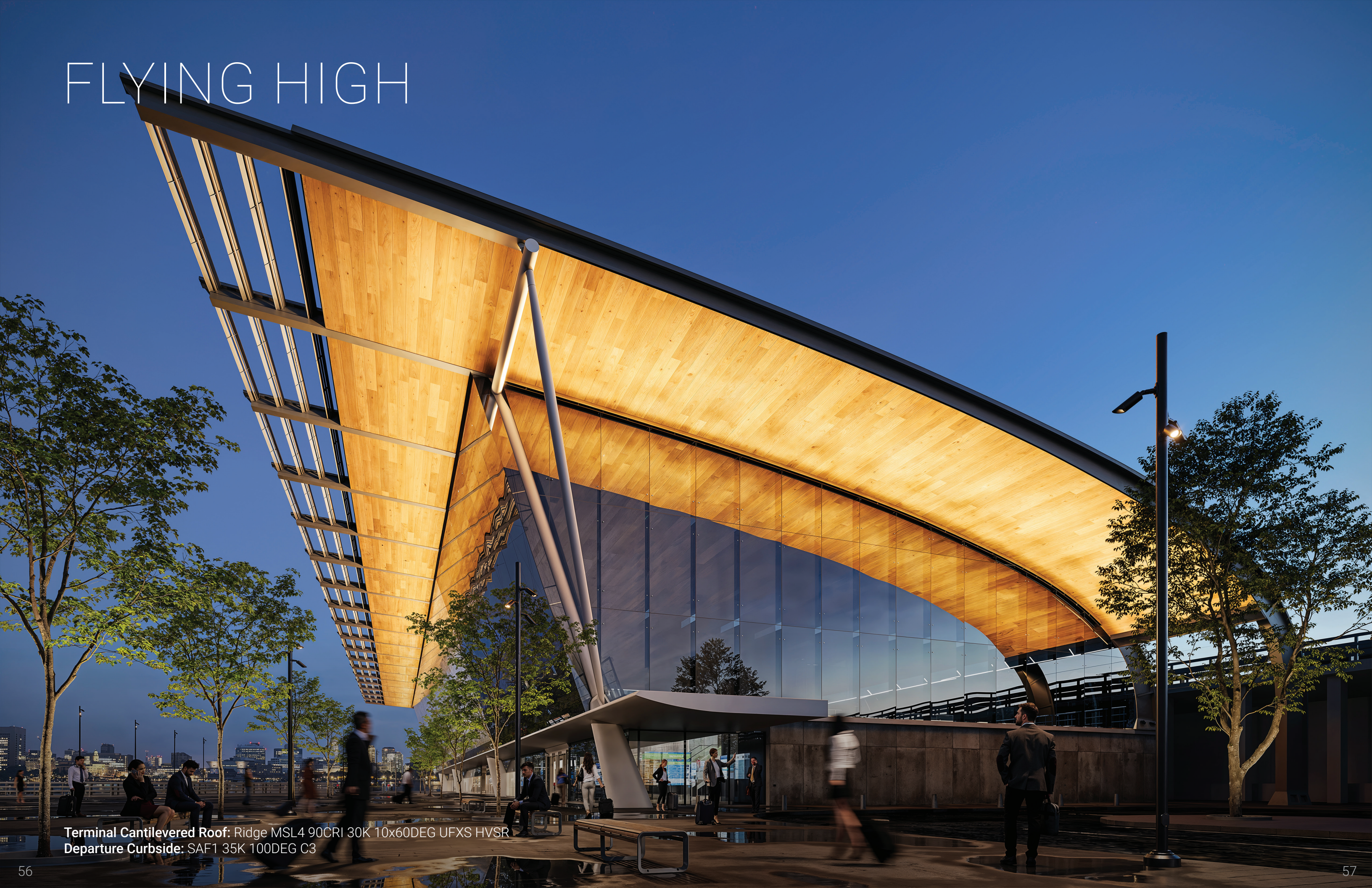

Terminal Cantilevered Roof: Ridge MSL4 90CRI 30K 10x60DEG UFXS HVSR
Departure Curbside: SAF1 35K 100DEG C3

SMART AUTOMATION

Ridge is compatible with a wide range of industry-standard control protocols—including 0-10V, Phase Dimming, DMX, and DALI—enabling dynamic lighting effects, granular fixture control, and improved energy efficiency.

- Supports complexity, scalability and integration needs
- Greater integration flexibility for diverse project needs
- Enhanced customization and dynamic lighting effects
- Improved energy management and operational efficiency

0-10V

Dims to 1%
Simplicity
Compatible
Flicker-Free

PHASE DIMMING

Dims to 1%
Retrofit Projects
Improved Efficiency
Specialized Dimmers/Wiring Requirements

DALI

Dims to <1%
More Advanced Network-Based Control
Individual Fixture Addressing
64 Devices
Scene Setting/Switching
Building Automation System

DMX

Dims to <1%
Advanced Network-Based Control
Granular Control of Fixtures
512 Channels Per Universe
Theatrical/Dynamic Luminaires
Performance Base

PRECISION MEETS CONTROL

Ridge's versatile linear floodlights—available in RGBW, static white, monochromatic colors, and with 1ft resolution—are fully compatible with the Animate™ Controller by nLight®.

This integration empowers designers to deliver both practical and outdoor, expressive outdoor lighting environments, combining energy optimization, code compliance, and enhanced occupant comfort with the creative flexibility of DMX control—while unlocking the full potential of Ridge's precision and versatility.

Through Pathscope software, users can easily create static and dynamic scenes, while scaling up to four universes using DMX, sACN, Art-Net, KiNET, and Pathway ssACN protocols.

With Ridge and Animate Controller, you get a complete, scalable solution for everyday lighting and immersive visual experiences.



Learn more: [Download Ridge RGBW Spec Sheet](#)

BEYOND THE RIDGE

SEAMLESS FUNCTIONALITY

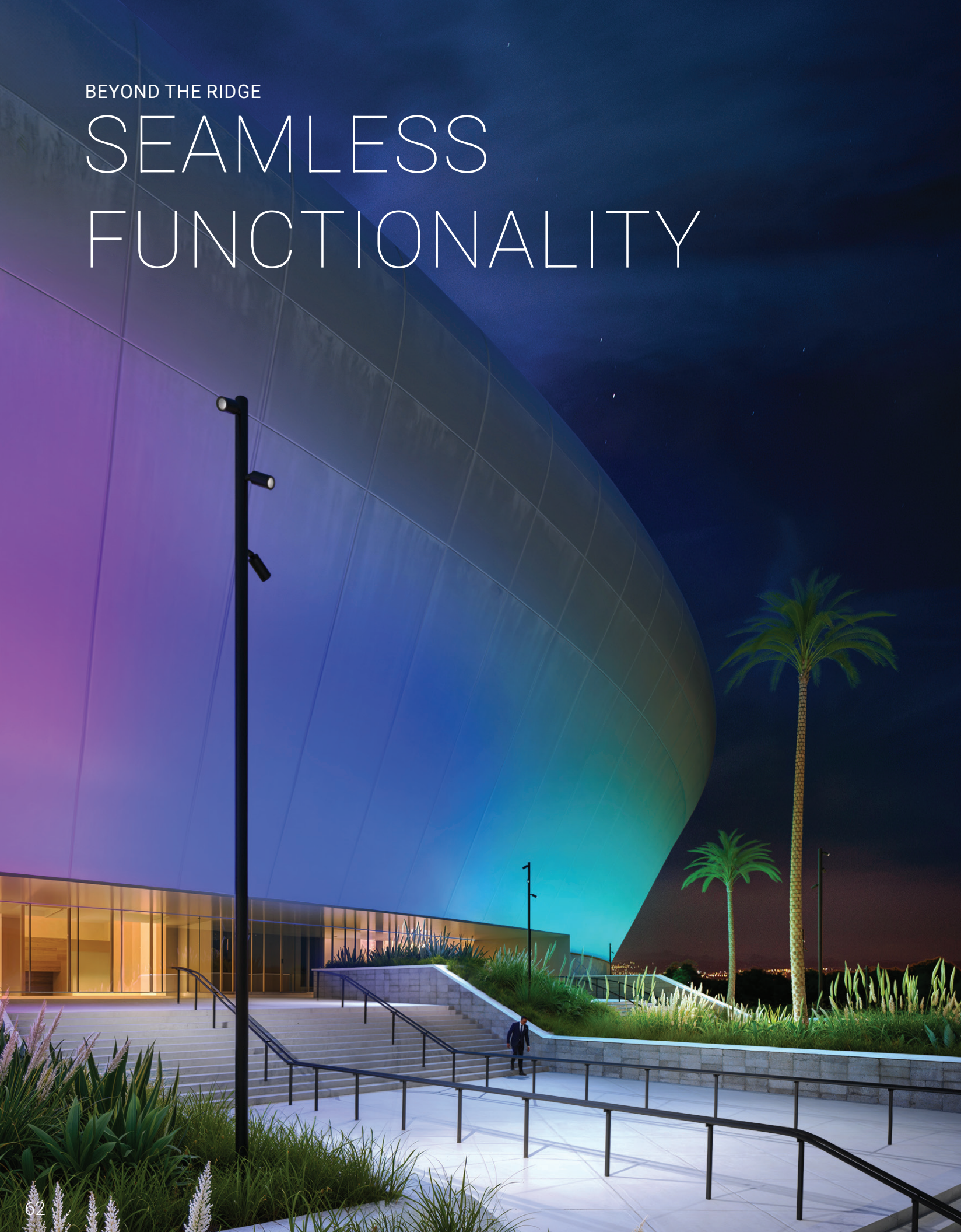

DISTRIBUTIONS



OPTIONS



COMPLIANCE



COLOR TEMPERATURES

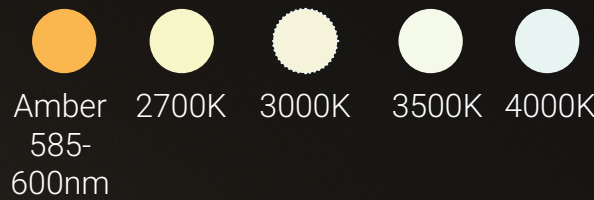

LIGHTING CONTROLS

0-10V Phase Dimming DMX/RDM DALI

COLOR CHANGING

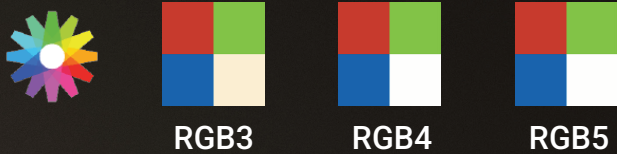

DELIVERED LUMENS

Static White: Up to 9000 DL, 2100 lm/ft & 150,000 CBCP

RGBW Quad Tech: Up to 6,400 DL, 1,700 lm/ft & 110,600 CBCP



LET'S CONNECT

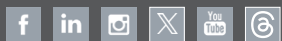

[Hydrel.com](https://www.hydrel.com)

Phone: 800.705.SERV (7378)

Email: Tech support - Techsupport-hydrel@acuitybrands.com

©2025 Acuity Brands Lighting, Inc. All rights reserved.

